

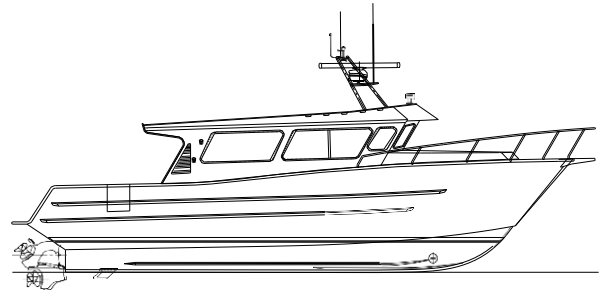

EAGLECRAFT 40 CRUISER

EAGLECRAFT BOATS ARE CUSTOM DESIGNED AND UNIQUE TO YOU. WORK WITH OUR DEDICATED AND SKILLED TEAM TO DEVELOP THE ULTIMATE CRUISER, FISHING MACHINE, OR MULTI-PURPOSE ADVENTURE VESSEL TO SUIT YOUR NEEDS AND LIFESTYLE.

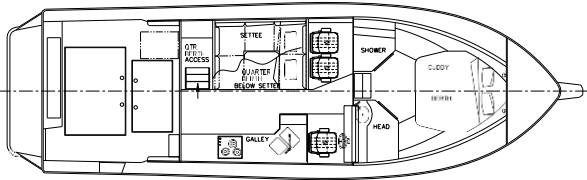

SPECIFICATIONS

Length (bow to swim grid): 40'6"

Beam : 13

Weight: Approx. 25,000 lbs

Fuel capacity: 300 US Gal/ 1136 liters/ 240 IMP Gal

Fresh water: 70 US Gal / 287 liters / 22 IMP Gal

Accommodations: Seating for 8 / Sleeping for 6

FEATURES

- U-Shaped settee seating for 6, sleeps 6 and 2 spacious staterooms
- Walk thru' side and Transom door in cockpit
- Large 150 Cubic Foot cockpit storage compartment
- 10" Bow thruster
- Diesel hydronic heating, engine bus heaters and defrost systems
- Sound proofed engine compartment with engine hatch on hydraulic lifts
- Windshield wipers with intermittent controls & washers
- 10 cu. ft. side by side fridge/freezer
- Propane stove and micro wave / convection oven
- LED Courtesy lights on stairs and in cuddy area
- Separate head and shower compartment
- Vacu-flush head system
- Non-slip deck coatings
- Bomar hatches with screens
- Fish hold, bait tanks, downriggers
- Log Skegs

CONTACT US



BOATS@EAGLECRAFT.COM



2177 ISLAND HWY, CAMPBELL RIVER, B.C.
CANADA, V9W 2G6



(250) 286-6749



EAGLECRAFT DIFFERENCE

CONSTRUCTION

Custom, high quality, commercial grade construction with heavy gauge aluminum construction methods

- Each Welder/Fabricator is Canadian Welding Bureau certified in aluminum welding
- Constructed to ABYC standards (where applicable)



BESPOKE EXPERIENCE

Custom designed to meet your needs with our "in house" design team

- Designed to be the ultimate cruiser, fishing machine or multi purpose adventure vessel unique to you
- Your choice of finishes , colors, and equipment
- Experience of working with our dedicated and skilled team to create and build your ultimate vessel

DESIGN

Shares design heritage with our regarded commercial vessel designs with safety, performance, strength, & durability in mind

- Several layout options available all with centerline queen size berth with separate shower and head
- 2nd berth layout with additional head available
- Excellent and predictable seakeeping characteristics with exceptional performance
- Designed for twin diesel stern drive with SeaKeeper and generator available
- Sound mitigation and insulation materials used throughout for enhanced interior environment
- Diesel Hydronic heat system with defrost system and hot water capability



CONTACT US



BOATS@EAGLECRAFT.COM



(250) 286-6749



2177 ISLAND HWY, CAMPBELL RIVER, B.C.
CANADA, V9W 2G6



EAGLECRAFT.COM

HULL & SUPERSTRUCTURE

- 40' LOA x 13' beam hull. Fabricated with 1/4" 5086 alloy bottom & side plate, polyurethane foam flotation, 7 welded cleats
- Deep Transverse frames every 18" to 24" welded at every longitudinal stringer & gunwale
- Keel doubler 1/4" 2" x 2" angle welded on full length of keel
- Soundproof Hull with acoustic materials in cuddy cabin and under main cabin sole.
- Log Skegs
- Forward leaning cabin. Includes insulation with laminate paneling with wood trim, paint on aluminum surfaces.
- Commercial grade windows- 4 sliding
- High Profile Cuddy Cabin
- 300 US Gal/ 1136 Liter/ 250 Imp Gal Aluminum Fuel tank
- 70 US gal/ 287 liter/ 60 Imp plastic water tank with gauge
- (3) 2000 gph bilge pump w float switch, high water alarm
- Flush mount engine compartment lid on gas struts with drainage, water tight bulkhead
- 40" extended hardtop with drainage for cabin roof
- Aft Deck: 110" long x 124" wide with self bailing deck
- Aft Cockpit lazarette storage - Large locker lid with gas struts, in cockpit sole with overboard drainage
- Transom door
- 1" aluminum bow railing extending part way down cabin
- Extended swim platform with 4 step collapsible ladder
- Bottom Paint and Non skid paint systems

ENGINE/ MECHANICAL/ SYSTEMS

- Twin Volvo Penta D6 400hp with DPI outdrive, common rail electronic fuel injection. Slow speed trolling, Freshwater cooled, Plumbed to hot water heater, & heat system
- Dual Racor 75/500 Filter system with vacuum gauge
- Trim tabs
- 11 US gal/ 45 Liter S.S. Hot water heater 110 vlt / engine
- 30,000 btu hydronic diesel furnace
- Engine based cabin heat system
- Defrost dash cowling system for forward windshield
- Windlass with foot pedals & helm controls, plow anchor, 50' 5/16" Chain, 300' nylon rode

ELECTRICAL SYSTEM

- 150 amp Volvo Penta alternators
- 40 amp battery charger
- Blue Sea 12 volt system with switches/ fuses
- Blue sea 120 vlt /50 amp panel with breakers, 50' smart cord, (6) 110vlt outlets, galvanic isolator
- Blue Sea automatic charge relays with manual over ride
- (2) AGM starting batteries 31 Series,
- (2) AGM house batteries 6 volt
- Tinned Marine Grade wiring with labeled heat shrink connections

GALLEY/ MAIN CABIN

- "U" Shaped Dinette, seats 5-6, sleeps 2, with cloth seating cushions
- (table lowers to convert additional berth)
- Mechanical suspension seats, Black Vinyl Helm, Co-pilot Mounted on storage boxes
- Custom galley cabinetry custom designed to fit your needs. Your choice of wood laminate finishes
- (2) 11lb Fiberglass propane tank mounted in storage box in cockpit with propane gas detector and solenoid
- 3 burner propane cooktop
- 4.3ft 12/110vt Refrigerator/ Freezer
- stainless steel sink, with pull out single lever faucet
- LED lights on dimmer switch, switchable to red
- LED courtesy lights
- (2) USB outlets
- Ventilation Vent
- CO Sensor

Delivery includes 1 day of training

QUARTER BERTH

- Queen size foam mattress , laminate bulkheads, insulated, LED lights and reading lights
- Hanging closet and storage compartment

NAVIGATION

- Richie compass with light
- S.S. air horn
- I-com VHF Radio with 8' antenna
- LED Navigation lights
- Cockpit spreader light
- 2 Wipers with washer system
- Radar Mast with hinge system

CUDDY CABIN/ HEAD

- Island style berth, laminate bulkheads, hull & deck insulation with hull quality hull liner & Soft touch headliner.
- Queen size memory foam mattress with storage underneath
- Hanging closets and storage
- Head with Vacuflush toilet with holding tank and overboard discharge, Vanity with sink, 126 liters/ 28 US gallon holding tank, port hole, Ventilation Vent, LED lighting
- Your choice of wood laminate finishes
- Shower compartment with hot and cold fixture, drainage, LED lighting & ventilation
- (2) 19" x 19" hatch with screen & shade
- LED lighting with courtesy light

CONTACT US



BOATS@EAGLECRAFT.COM



(250) 286-6749



2177 ISLAND HWY, CAMPBELL RIVER, B.C.
 CANADA, V9W 2G6



POPULAR CUSTOM OPTIONAL EQUIPMENT

PREFERRED OPTION PACKAGE

- Upgrade to 70 US gal/ 287 liter/ 60 Imp Stainless Steel water tank
- Upgrade to 7.0 ft 12/110vlt Refrigerator/ Freezer - S.S.
- Microwave package with outlet and cabinet
- Upgrade to premium suspension helm & co-pilot seats with height adjustable, more travel, swivels
- Remote spotlight
- Recessed Bow Docking Light
- 10" 24 volt Commercial Bow Thruster with AGM battery
- 2800 watt inverter(12 vlt to 120 vlt)/ battery charger with remote panel, upgrade to (2) pair (4) AGM house batteries, upgrade from standard 40 amp battery charger
- Northern Lights 6 kw diesel generator
- Remote Battery Switches for house and start batteries

ENGINE/ MECHANICAL/ SYSTEM OPTIONS

- Upgrade to Twin Volvo Penta D6 440 Diesels
- Rear 2nd station with Volvo controls, steering, including console with bow thruster controls
- Joystick Docking and driving with Twin Volvo Package(2 joystick—Main and aft helm)
- Dynamic Positioning with position hold Twin Volvo Package
- Increase fuel tank to 350 US Gallon
- Seakeeper 5
- Upgrade trim tabs to automated interceptor system
- 3 additional 120 volt A.C. outlets
- (2) 150 watt solar panel charging kit with charge controller
- Water maker 14 US gal hr water maker automated controls

COMMAND BRIDGE

- Command Bridge with seating for 3 on plastic seats, aluminum railings and ladder, covers for bridge & seating, Volvo controls & gauges, bow thruster controls, trim tab controls, horn

SAFETY PACKAGE

- 6 Person Life raft with hydrostatic release mounted on cabin roof
- 6 Adult Keyhole Life vest, Flare kits,(5) 5/8" x 20 ft braided lines, (5) G5 bumpers w lines, life ring w line, (2)Fire Extinguisher 5# Dry, CO/ Smoke detector, 200 piece tool kit, boat hook

Additional Custom Options & Equipment Available Upon Request
All vessels are custom designed to fit our customers specific needs

EXTERIOR OPTIONS

- Walk-thru side door 20" opening in cockpit
- Hull Vinyl wrap color
- Cabin Vinyl wrap color
- Sure shade power sun shade
- Upgrade to high bow railings
- Aft Deck railings
- Swim grid railings with 2 down rigger mounts
- Aft Deck folding bench seat with removable cushions
- Ladder to cabin roof with hatch

INTERIOR OPTIONS

- Select interior colors including wood grain , counters, paint , and upholstery
- Enclose quarter berth entrance with folding door and top
- Install additional head and small sink in quarter berth closet
- Storage compartment in cabin sole
- Upgrade counters to Corian

ELECTRONICS

- Garmin 8612xsv 12" chart plotter w sonar, 18" fantom radar dome, GT51 transducer, Garmin Grid
- Increase Chart plotter size to 8616xsv 16" display
- Additional 12 " Garmin display
- Additional 16 " Garmin display
- AIS system (transmit and received networked to Garmin Displays)
- Stereo Fusion AM/FM unit with Bluetooth, UBS, AUX with (4) JL AUDIO speakers
- Remote vessel monitoring system for Bilge Pump, Battery, Temperature, Shore power, & vessel position

FISHING PACKAGE

- Kicker Package- Yamaha 25 hp Kicker extra long shaft, hydraulic steering system, with hydraulic bracket, 45 liter/11 us gal fuel tank, fuel filter, fuel gauge
- Fish box built in aft gunwale(2) 12 vlt Scotty downriggers, Pot hauler,
- 8 Aluminum rod holders across the transom or cabin roof extension
- 6 Burnewiin thru gunwale rod holders with cleaning table
- Custom Tackle center
- Raw water wash down system, 6 gpm / 70 psi, cockpit outlet, hose, nozzle
- Fresh water wash down outlet in cockpit, connected to fresh water system, hose, nozzle

(Pricing Subject to Change without notice)

DAVIT AND DINGHY / MOUNTS

- (9') aluminum rigid/ inflatable hull, 300 lbs davit w electric winch, roof cradle, bridle

CONTACT US



BOATS@EAGLECRAFT.COM



2177 ISLAND HWY, CAMPBELL RIVER, B.C.
 CANADA, V9W 2G6



(250) 286-6749

