

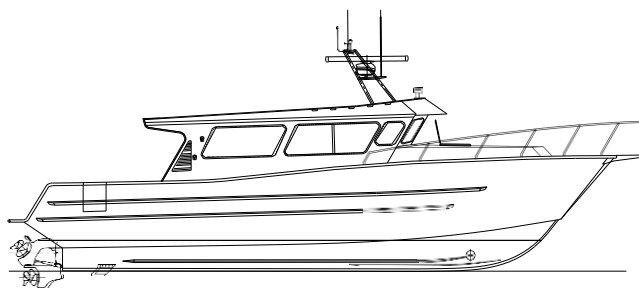

EAGLECRAFT 43 CRUISER

EAGLECRAFT BOATS ARE CUSTOM DESIGNED AND UNIQUE TO YOU. WORK WITH OUR DEDICATED AND SKILLED TEAM TO DEVELOP THE ULTIMATE CRUISER, FISHING MACHINE, OR MULTI-PURPOSE ADVENTURE VESSEL TO SUIT YOUR NEEDS AND LIFESTYLE.

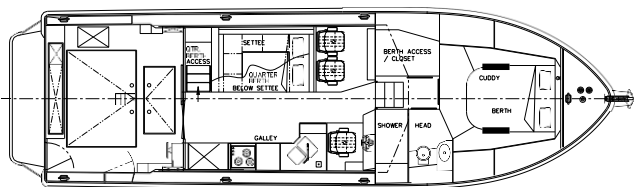

SPECIFICATIONS

Length (bow to swim grid): 43'6"

Beam : 13

Weight: Approx. 27,000 lbs

Fuel capacity: 300 US Gal/ 1136 liters / 250 IMP Gal

Fresh water: 70 US Gal / 287 liters /60 IMP Gal

Waste holding tank: 28 US Gal/105 liters/22 IMP Gal

Accommodations: Seating for 8 / Sleeping for 6

FEATURES

U-shaped settee seating for 8, sleeps 8 and 3 spacious staterooms

Walk thru side and transom door in cockpit

Large 150 cubic foot cockpit storage compartment 10" Bow thruster

Diesel hydronic heating, engine bus heaters and defrost systems

Sound proofed engine compartment with engine hatch on hydraulic lifts

Windshield wipers with intermittent controls & washers

10 Cu. Ft. Side by side fridge/freezer

Propane stove and micro wave / convection oven LED courtesy lights on stairs and in cuddy area Separate head and shower compartment

Vacu-flush head system Non-slip deck coatings Bomar hatches with screens

Fish hold, bait tanks, downriggers Log skegs

CONTACT US



BOATS@EAGLECRAFT.COM



2177 ISLAND HWY, CAMPBELL RIVER, B.C.
CANADA, V9W 2G6



(250) 286-6749



EAGLECRAFT DIFFERENCE

CONSTRUCTION

Custom, high quality, commercial grade construction with heavy gauge aluminum construction methods

- Each Welder/Fabricator is Canadian Welding Bureau certified in aluminum welding
- Constructed to ABYC standards (where applicable)



BESPOKE EXPERIENCE

Custom designed to meet your needs with our "in house" design team

- Designed to be the ultimate cruiser, fishing machine or multi purpose adventure vessel unique to you
- Your choice of finishes , colors, and equipment
- Experience of working with our dedicated and skilled team to create and build your ultimate vessel

DESIGN

Shares design heritage with our regarded commercial vessel designs with safety, performance, strength, & durability in mind

- Several layout options available all with centerline queen size berth with separate shower and head
- 3 berth layout with additional head available
- Excellent and predictable seakeeping characteristics with exceptional performance
- Designed for twin diesel stern drive with SeaKeeper and generator available
- Sound mitigation and insulation materials used throughout for enhanced interior environment
- Diesel Hydronic heat system with defrost system and hot water capability



CONTACT US



BOATS@EAGLECRAFT.COM



2177 ISLAND HWY, CAMPBELL RIVER, B.C.
CANADA, V9W 2G6



(250) 286-6749



HULL & SUPERSTRUCTURE

- 43' LOA x 13' beam hull. Fabricated with 1/4" 5086 alloy bottom & side plate, polyurethane foam flotation, 7 welded cleats
- Deep Transverse frames every 18" to 24" welded at every longitudinal stringer & gunwale
- Keel doubler 1/4" 2" x 2" angle welded on full length of keel
- Soundproof Hull with acoustic materials in cuddy cabin and under main cabin sole.
- Log Skegs
- Forward leaning cabin. Includes insulation with laminate paneling with wood trim, paint on aluminum surfaces.
- Commercial grade windows- 4 sliding
- High Profile Cuddy Cabin
- 300 US Gal/ 1136 Liter/ 250 Imp Gal Aluminum Fuel tank
- 70 US gal/ 287 liter/ 60 Imp plastic water tank with gauge
- (3) 2000 gph bilge pump w float switch, high water alarm
- Flush mount engine compartment lid on gas struts with drainage, water tight bulkhead
- 40" extended hardtop with drainage for cabin roof
- Aft Deck: 110" long x 124" wide with self bailing deck
- Aft Cockpit lazarette storage - Large locker lid with gas struts, in cockpit sole with overboard drainage
- Transom door
- 1" aluminum bow railing extending part way down cabin
- Extended swim platform with 4 step collapsible ladder
- Bottom Paint and Non skid paint systems

GALLEY/ MAIN CABIN

- "U" Shaped Dinette, seats 5-6, sleeps 2, with cloth seating cushions
- (table lowers to convert additional berth)
- Mechanical suspension seats, Black Vinyl Helm, Co-pilot Mounted on storage boxes
- Custom galley cabinetry custom designed to fit your needs. Your choice of wood laminate finishes
- (2) 11lb Fiberglass propane tank mounted in storage box in cockpit with propane gas detector and solenoid
- 3 burner propane cooktop
- 4.3ft 12/110vt Refrigerator/ Freezer
- stainless steel sink, with pull out single lever faucet
- LED lights on dimmer switch, switchable to red
- LED courtesy lights
- (2) USB outlets
- Ventilation Vent
- CO Sensor

QUARTER BERTH

- Queen size foam mattress , laminate bulkheads, insulated, LED lights and reading lights, accessed behind settee
- Hanging closet and storage compartment

ENGINE/ MECHANICAL/ SYSTEMS

- Twin Volvo Penta D6 440hp with DPI outdrive, common rail electronic fuel injection. Slow speed trolling, Freshwater cooled, Plumbed to hot water heater, & heat system
- Dual Racor 75/500 Filter system with vacuum gauge
- Trim tabs
- 11 US gal/ 45 Liter S.S. Hot water heater 110 vlt / engine
- 30,000 btu hydronic diesel furnace
- Engine based cabin heat system
- Defrost dash cowling system for forward windshield
- Windlass with foot pedals & helm controls, plow anchor, 50' 5/16" Chain, 300' nylon rode

ELECTRICAL SYSTEM

- 150 amp Volvo Penta alternators
- 40 amp battery charger
- Blue Seas 12 volt system with switches/ fuses
- Blue Seas 120 vlt /50 amp panel with breakers, 50' smart cord,
- (6) 110vlt outlets, galvanic isolator
- Blue Seas automatic charge relays with manual over ride
- (2) AGM starting batteries 31 Series,
- (2) AGM house batteries 6 volt
- Tinned Marine Grade wiring with labeled heat shrink connections

NAVIGATION

- Richie compass with light
- S.S. air horn
- I-com VHF Radio with 8' antenna
- LED Navigation lights
- Cockpit spreader light
- 2 Wipers with washer system
- Radar Mast with hinge system

CUDDY CABIN/ HEAD

- Island style berth, laminate bulkheads, hull & deck insulation with hull quality hull liner & Soft touch headliner with access door
- Queen size memory foam mattress with storage underneath
- Hanging closets and storage
- Head with Vacuflush toilet with holding tank and overboard discharge, Vanity with sink, 126 liters/ 28 US gallon holding tank, port hole, Ventilation Vent, LED lighting
- Your choice of wood laminate finishes
- Shower compartment with hot and cold fixture, drainage, LED lighting & ventilation
- (2) 19" x 19" hatch with screen & shade
- LED lighting with courtesy light

CONTACT US



BOATS@EAGLECRAFT.COM

 2177 ISLAND HWY, CAMPBELL RIVER, B.C.
 CANADA, V9W 2G6

(250) 286-6749



POPULAR CUSTOM OPTIONAL EQUIPMENT

PREFERRED OPTION PACKAGE

- Upgrade to 70 US gal/ 287 liter/ 60 Imp Stainless Steel water tank
- Upgrade to 7.0 ft 12/110vlt Refrigerator/ Freezer - S.S.
- Microwave package with outlet and cabinet
- Upgrade to premium suspension helm & co-pilot seats with height adjustable, more travel, swivels
- Remote spotlight
- Recessed bow docking Light
- 10" 24 volt commercial bow thruster with AGM batteries
- 2800 watt inverter(12 vlt to 120 vlt)/ battery charger with remote panel, upgrade to (2) pair (4) AGM house batteries, upgrade from standard 40 amp battery charger
- Northern Lights 6 kw diesel generator
- Remote Battery Switches for house and start batteries

ENGINE/ MECHANICAL/ SYSTEM OPTIONS

- Rear 2nd station with Volvo controls, steering, including console with bow thruster controls
- Joystick Docking and driving with Twin Volvo Package(2 joystick—Main and aft helm)
- Dynamic Positioning with position hold
- Increase fuel tank to 350 US Gallon
- Seakeeper 5
- Upgrade trim tabs to automated interceptor system
- 3 additional 120 volt A.C. outlets
- (2) 150 watt solar panel charging kit with charge controller
- Water maker 14 US gal hr water maker automated controls

COMMAND BRIDGE

- Command Bridge with seating for 3 on plastic seats, aluminum railings and ladder, covers for bridge & seating, Volvo controls & gauges, bow thruster controls, trim tab controls, horn

SAFETY PACKAGE

- 6 Person Life raft with hydrostatic release mounted on cabin roof
- 6 Adult Keyhole Life vest, Flare kits,(5) 5/8" x 20 ft braided lines, (5) G5 bumpers w lines, life ring w line, (2)Fire Extinguisher 5# Dry, CO/ Smoke detector, 200 piece tool kit, boat hook

Additional Custom Options & Equipment Available Upon Request
All vessels are custom designed to fit our customers specific needs

EXTERIOR OPTIONS

- Walk-thru side door 20" opening in cockpit
- Hull Vinyl wrap color
- Cabin Vinyl wrap color
- Sure shade power sun shade
- Upgrade to high bow railings
- Aft Deck railings
- Swim grid railings with 2 down rigger mounts
- Aft Deck folding bench seat with removable cushions
- Ladder to cabin roof with hatch

INTERIOR OPTIONS

- Select interior colors including wood grain , counters, paint , and upholstery
- Enclose quarter berth entrance with folding door and top
- Install additional head and small sink in quarter berth closet
- Storage compartment in cabin sole
- Upgrade counters to Corian

ELECTRONICS

- Garmin 8612xsv 12" chart plotter w sonar, 18" fantom radar dome, GT51 transducer, Garmin Grid
- Increase Chart plotter size to 8616xsv 16" display
- Additional 12 " Garmin display
- Additional 16 " Garmin display
- AIS system (transmit and received networked to Garmin Displays)
- Stereo Fusion AM/FM unit with Bluetooth, UBS, AUX with (4) JL AUDIO speakers
- Remote vessel monitoring system for Bilge Pump, Battery, Temperature, Shore power, & vessel positio

FISHING PACKAGE

- Kicker Package- Yamaha 25 hp Kicker extra long shaft, hydraulic steering system, with hydraulic bracket, 45 liter/11 us gal fuel tank, fuel filter, fuel gauge
- Fish box built in aft gunwale(2) 12 vlt Scotty downriggers, Pot hauler,
- 8 Aluminum rod holders across the transom or cabin roof extension
- 6 Burnewiin thru gunwale rod holders with cleaning table
- Custom Tackle center
- Raw water wash down system, 6 gpm / 70 psi, cockpit outlet, hose, nozzle
- Fresh water wash down outlet in cockpit, connected to fresh water system, hose, nozzle

(Pricing Subject to Change without notice)

DAVIT AND DINGHY / MOUNTS

- (9') aluminum rigid/ inflatable hull, 300 lbs davit w electric winch, roof cradle, bridle

CONTACT US



BOATS@EAGLECRAFT.COM



2177 ISLAND HWY, CAMPBELL RIVER, B.C.
 CANADA, V9W 2G6



(250) 286-6749

