

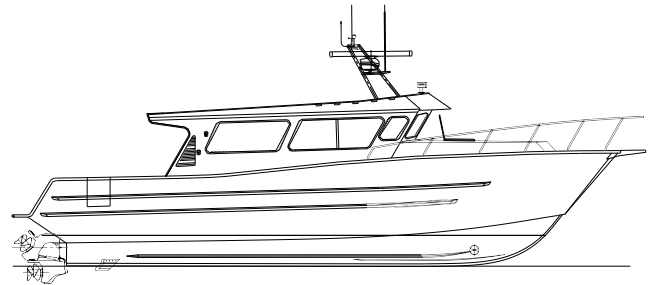

EAGLECRAFT 34
CRUISER

EAGLECRAFT BOATS ARE CUSTOM DESIGNED AND UNIQUE TO YOU. WORK WITH OUR DEDICATED AND SKILLED TEAM TO DEVELOP THE ULTIMATE CRUISER, FISHING MACHINE, OR MULTI-PURPOSE ADVENTURE VESSEL TO SUIT YOUR NEEDS AND LIFESTYLE.

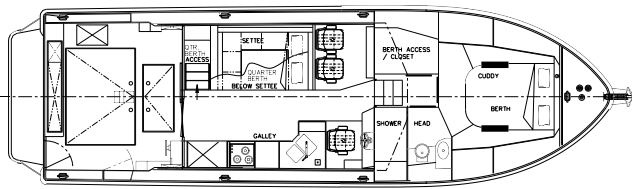

SPECIFICATIONS

Length (bow to swim grid): 34'6"

Beam : 11'

Weight: Approx. 14,000 – 16,000 lbs

Fuel capacity: 300 US Gal Outboards/ 160-200 US Gal Diesel

Fresh water: 50 US Gal / 190 liters

Waste holding tank: 28 US Gal/105 liters

Accommodations: Seating for 6-7 / Sleeping for 4-6

FEATURES

- Spacious cuddy cabin with V- berth configuration
- Main cabin seats 6 with optional quarter berth under settee.
- Settee converts to additional berth
- Well appointed cabin interior with custom interior, upholstery, and counter tops Custom designed galley cabinetry and layout
- Full head with shower and vanity
- Sound mitigation materials
- Optional 2' fishing aft deck extension (requires upgraded propulsion)
- Diesel furnace and bus heater / defroster
- 3000 watt inverter/ battery charger system with agm batteries, dual engine start batteries. Shore power with galvanic isolator with Smart Plug and Cord 8
- Bow Thruster
- L.E.D lighting
- Electric Windlass with anchor package

CONTACT US

 BOATS@EAGLECRAFT.COM

 (250) 286-6749

 2177 ISLAND HWY, CAMPBELL RIVER, B.C.
CANADA, V9W 2G6



EAGLECRAFT DIFFERENCE

CONSTRUCTION

Custom, high quality, commercial grade construction with heavy gauge aluminum construction methods

- Each Welder/Fabricator is Canadian Welding Bureau certified in aluminum welding
- Constructed to ABYC standards (where applicable)



BESPOKE EXPERIENCE

Custom designed to meet your needs with our "in house" design team

- Designed to be the ultimate cruiser, fishing machine or multi purpose adventure vessel unique to you
- Your choice of finishes , colors, and equipment
- Experience of working with our dedicated and skilled team to create and build your ultimate vessel

DESIGN

Shares design heritage with our regarded commercial vessel designs with safety, performance, strength, & durability in mind

- Commercial grade hull design heritage, and structural integrity
- 1 or 2 berth layout with additional head available
- Excellent and predictable seakeeping characteristics with exceptional performance
- Designed for Twin Outboards, or single or twin Volvo diesel stern drives
- Sound mitigation and insulation materials used throughout for enhanced interior environment
- Diesel Hydronic heat system with defrost system and hot water capability



CONTACT US



BOATS@EAGLECRAFT.COM



(250) 286-6749



2177 ISLAND HWY, CAMPBELL RIVER, B.C.
CANADA, V9W 2G6



EAGLECRAFT.COM

HULL & SUPERSTRUCTURE

- 34 6' LOA x 11' beam hull. Fabricated with 1/4" 5086 alloy bottom & side plate, polyurethane insulation, 7 welded cleats
- Deep transverse frames every 18" to 26" welded at every longitudinal stringer & gunwale
- Keel doubler 1/4" 2" x 2" welded on full length of keel
- Soundproof hull with acoustic materials cuddy cabin and under main cabin sole.
- Log skegs
- Forward leaning cabin. Includes insulation with synthetic wood grain paneling with wood trim, paint on aluminum surfaces.
- Commercial grade windows—3 sliding
- High Profile Cuddy Cabin design
- Outboards - 300 US Gal/ 1135 Liter Aluminum Fuel tank
- Diesel- 160-200 US Gal Aluminum Fuel tank depending on engine size
- 50 US gal/ water tank with gauge
- (2 or 3) of 2000 gph bilge pump w float switch
- 40" extended hardtop with drainage for cabin roof
- Large aft deck with self bailing drainage
- Aft Cockpit lazarette storage - large locker, lid with gas struts, in cockpit sole with overboard drainage
- Transom door
- 1" aluminum bow railing extending part way down cabin
- Extended swim platform with telescoping ladder
- Bottom Paint and Non skid Paint systems

GALLEY/ MAIN CABIN

- Your choice of with synthetic wood grain paneling with wood trim, counters, and cloth upholstery color options
- Dinette, seats 4, sleeps 2, with cloth seating cushions (table convert additional berth)
- Premium suspension helm with adjustable travel & height
- Custom galley cabinetry designed to fit your needs
- 2 burner electric induction cook top
- Microwave Package with outlet and below counter cabinet
- 12/110vlt Refrigerator/ Freezer - S.S.
- stainless steel sink, with pull out single lever faucet
- LED lights on dimmer switch, switchable to red
- LED courtesy lights
- (2) USB outlets
- Storage compartment in cabin sole
- Ventilation Vent
- CO Sensor

Includes 1 day of EagleCraft factory vessel training

ENGINE/ MECHANICAL/ SYSTEMS

- Twin Outboards— Twin Yamaha 350 , 450 XTO or Twin Mercury V10 400 hp , V12 600hp Verado
- Diesel Power - Single Volvo Penta D6 440 DPI or Twin Volvo Penta D4 320 DPI
- Fuel water separator filters
- Steer by wire system
- Electric trim tabs
- 11 US gal/ 45 Liter S.S. Hot water heater 110 vlt / Dsl engine
- 17,000 btu hydronic diesel furnace
- Defrost dash cowling system for forward windshield
- Windlass with foot pedals & helm controls, plow anchor, 50' 5/16" Chain, 300' nylon rode
- 8" 12 volt Commercial Bow Thruster with AGM battery

ELECTRICAL SYSTEM

- 3000 watt inverter(12 vlt to 120 vlt) & battery charger with remote panel
- 12 volt system with switches , breakers , & fuses
- Shore power 120 vlt /30 amp panel with breakers, 50' smart cord, 3 110vlt outlets, galvanic isolator
- automatic charge relays with manual over ride
- Helm mounted Remote Battery Switches for House and Start battery systems
- (2) AGM starting batteries 31 Series,
- (4) AGM house batteries 6 volt
- Tinned Marine Grade wiring with labeled heat shrink connections

NAVIGATION

- Richie compass with light
- S.S. air horn
- VHF Radio with 8' antenna & AIS system (Class B - transmit and received networked to Garmin Displays)
- LED Navigation lights
- LED Bow Docking light, Remote Spotlight ,Cockpit spreader light
- 2 Wipers with washer system
- Low Profile Radar Arch on cabin roof

CUDDY CABIN/ HEAD

- V- berth style bunk , synthetic wood grain paneling , hull & deck insulation with high quality hull liner & Soft touch headliner.
- Hanging closet and storage
- Your choice of with synthetic wood grain paneling with wood trim
- Head with Vacuflush toilet with 28 US gal holding tank and overboard discharge, Vanity with sink, port hole, Ventilation Vent, LED lighting, with hot and cold shower fixture, drainage,
- 19" x 19" hatch with screen & shade
- LED lighting with courtesy light

CONTACT US



BOATS@EAGLECRAFT.COM



(250) 286-6749



2177 ISLAND HWY,CAMPBELL RIVER, B.C.
 CANADA, V9W 2G6



POPULAR CUSTOM OPTIONAL EQUIPMENT

EXTERIOR OPTIONS

- 2' fishing aft deck extension (requires upgraded propulsion)
- Modern cabin design option (As pictured)
- Walk-around deck layout (Narrow Cabin)
- Walk-thru side door opening in cockpit
- Hull & cabin solid color wrap
- EagleShade sun/ mist shade
- Aft Deck folding bench seat with removable cushions
- Synthetic exterior non-skid decking
- Trailer ready option- Folding mast and lower cabin height
- Anchor wash down

ENGINE/ MECHANICAL/ SYSTEM OPTIONS

- Increase Outboard Fuel tank with upgraded Outboard sizing
- Increase Diesel Fuel tank when twin diesels selected
- 2nd helm controls with steering mounted on aft console
- Joystick docking System- Yamaha, Mercury or Volvo
- diesel generator
- SeaKeeper install ready kit
- Increase furnace to 30,000 btu's (required for second berth)
- Marine air conditioning system
- Additional 120 volt A.C. outlets
- 200 watt solar panel with charge controller
- Water maker 14 US gal hr with automated controls
- Portable Fridge Freezer in storage
- Upgrade microwave to convection microwave unit

DAVIT AND DINGHY / MOUNTS

- (9') aluminum rigid/ inflatable hull, 300 lbs hinged davit w electric winch, roof cradle, bridle

SAFETY PACKAGE

- 6 Person Life raft with hydrostatic release mounted on cabin roof
- 6 Adult Keyhole Life vest, Flare kits,(5) 5/8" x 20 ft braided lines, (3) G5 fenders w lines, life ring w line, (2)Fire Extinguisher 5# Dry,

Additional Custom Options & Equipment Available Upon Request
All vessels are custom designed to fit our customers specific needs
(Specifications & Options are subject to change without notice)

INTERIOR OPTIONS

- Commuter Cabin and Cuddy layout
- Second berth layout - Quarter Berth
- Enclose Second berth entrance for privacy
- Upgrade finishes to soft touch material at Cuddy berth and Second berth areas
- Upgrade to Corian counters in galley and head
- Upgrade upholstery to synthetic leatherette material

ELECTRONICS

- Garmin 12" chart plotter w sonar, 18" fantom x radar dome, transducer, Garmin Grid
- Increase Chart plotter size to 16" display
- Additional 12 " Garmin display
- Additional 16 " Garmin display
- AIS system (transmit and received networked to Garmin Displays)
- Stereo Fusion AM/FM unit with Bluetooth, USB, AUX with (6) Fusion speakers & sub, (2) JL AUDIO speakers on aft deck
- Night vision added to Garmin System

FISHING PACKAGE

- Kicker Package- Yamaha/Mercury 25 hp Kicker extra long shaft, (Twin engine outboards or single diesel only)
- Fish box(s) built in deck or in transom
- (2) 12 vlt electrical outlets for Scotty downriggers/ Pot hauler
- (8 Aluminum rod holders across the transom and/or cabin roof extension
- Burnewiin thru gunwale rod holders with cleaning table
- Custom Tackle center
- Raw water wash down system, 6 gpm / 70 psi, cockpit outlet, hose, nozzle
- Fresh water wash down outlet in cockpit, connected to fresh water system, hose, nozzle

CUSTOM OPTIONS NOTES

CONTACT US



BOATS@EAGLECRAFT.COM



2177 ISLAND HWY,CAMPBELL RIVER, B.C.
CANADA, V9W 2G6



(250) 286-6749

